

System 3D View

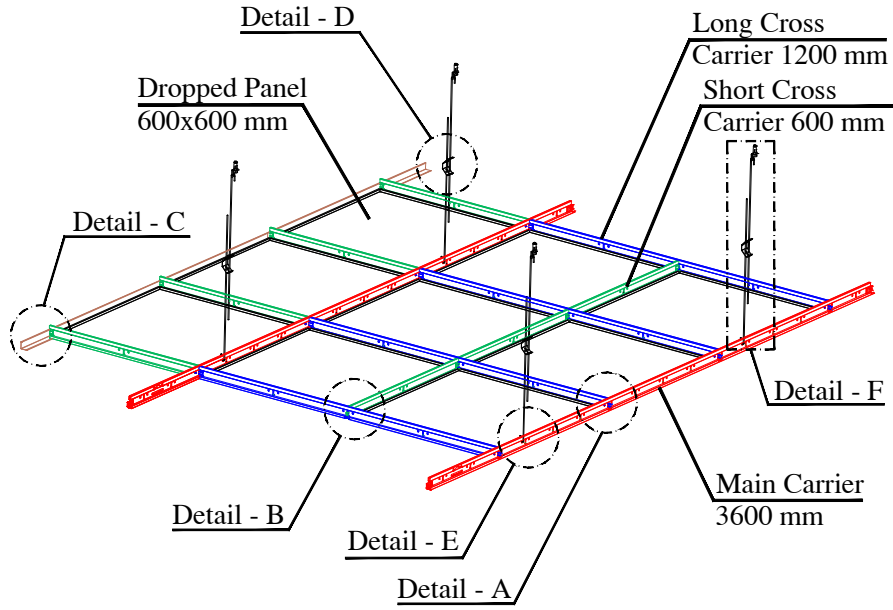

| System Material   | Plan | View A | View B | 3D View | Position in the System |
|---|------|--------|--------|---------|------------------------|
| Dropped Panel<br>584x584x8 mm<br>Galvanized Steel (T 0.7mm) |      |        |        |         |                        |
| Main Carrier<br>L: 3600 mm<br>Galvanized Steel              |      |        |        |         |                        |
| Long Cross Carrier<br>L: 1200 mm<br>Galvanized Steel        |      |        |        |         |                        |
| Short Cross Carrier<br>L: 600 mm<br>Galvanized Steel        |      |        |        |         |                        |

System Plan

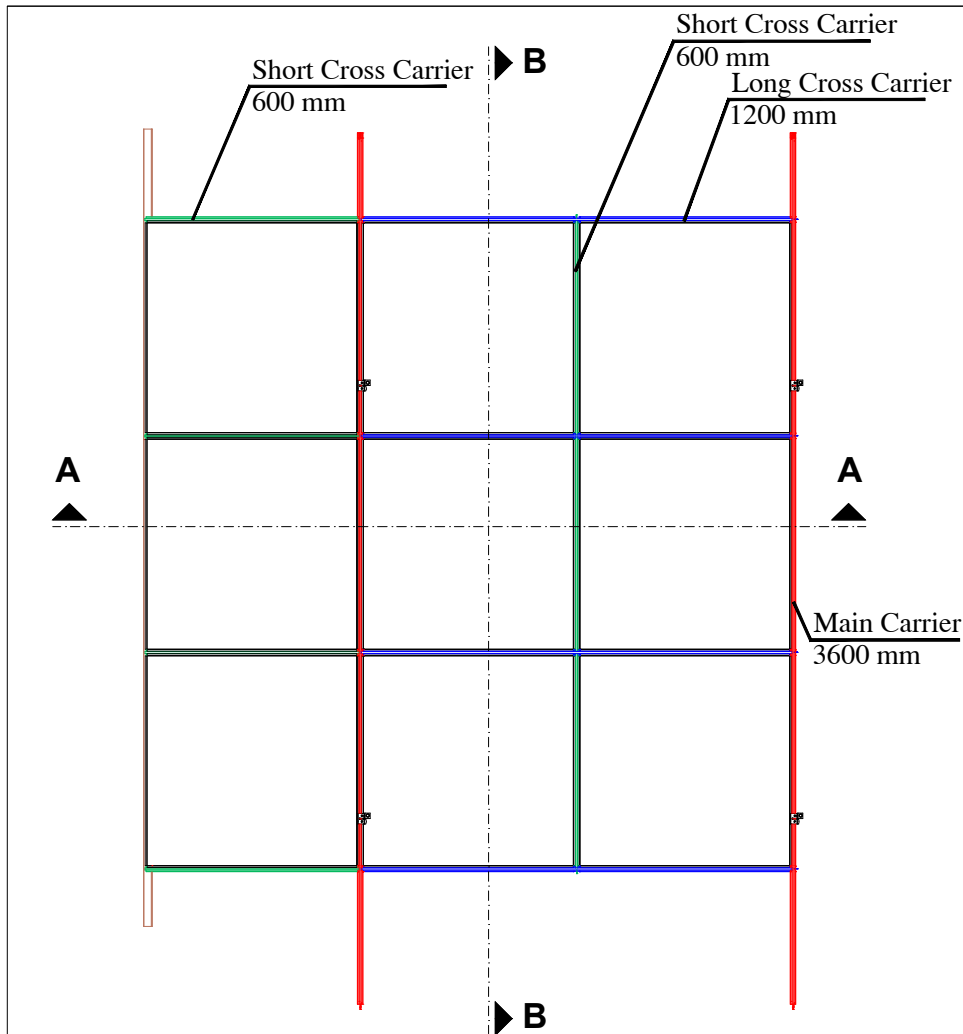

Section A-A

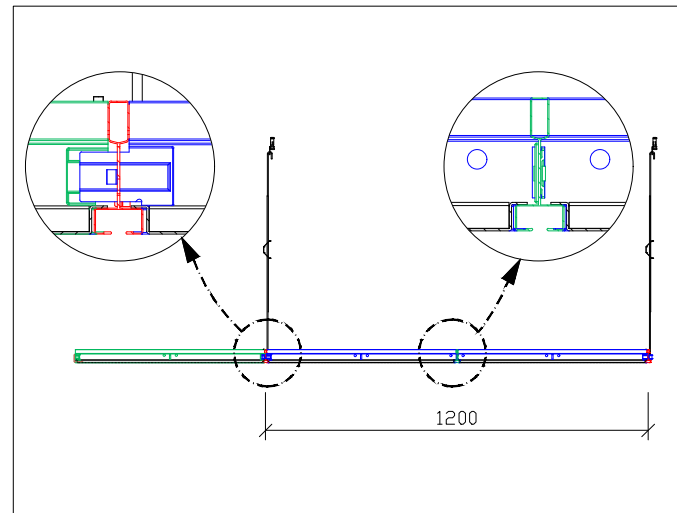

Section B-B

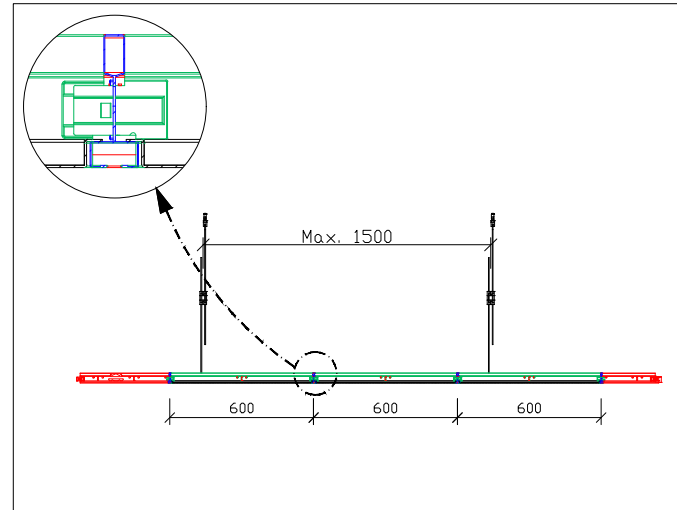

Detail A : Main Carrier to Long Cross Carrier 1200 mm Connection Detail

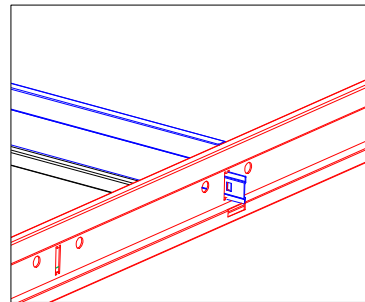

Detail B : Long Cross Carrier 1200 mm to Short Cross Carrier 600 mm Connection Detail

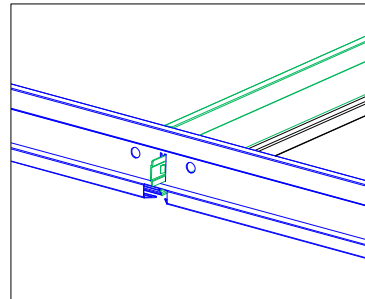

Detail E : Carriers Hanging Detail

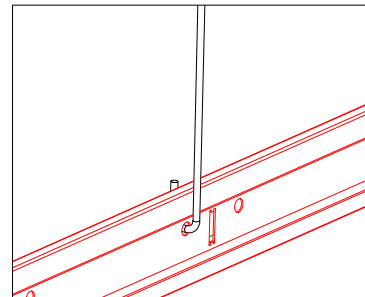

Detail C : L Perimeter Trim (Pre-Paint Steel) 3D View

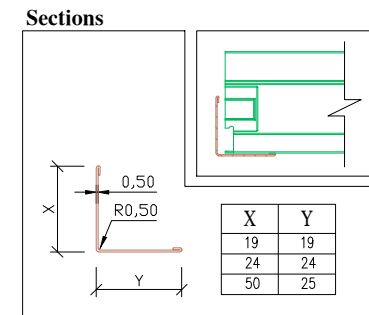
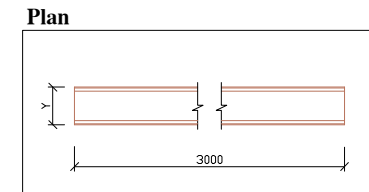
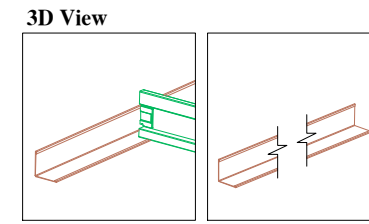

Detail D : Double Spring Clip (Spring Steel) 3D View

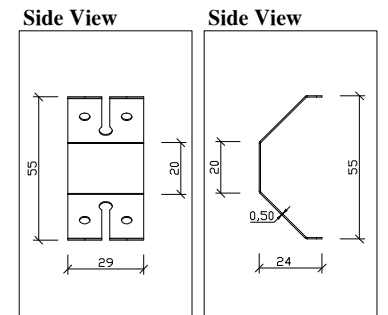
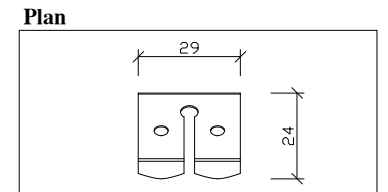
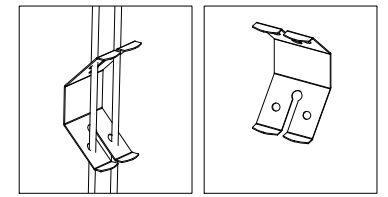

Detail F : Hanger Wire (Ø 4mm - Galvanized Steel)

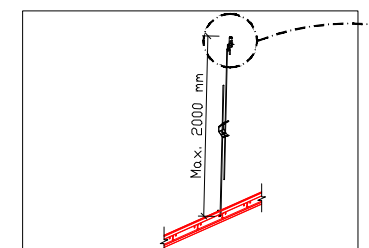

Anchor (Steel)

